

ASSEMBLY INSTRUCTIONS

Stool | 18"



PIECES

1 x



Middle Board

2 x



Side Board

2 x



Side Foot

2 x



Plastic Lock

10 x



Screw 2"

2 x



Screw 1"

12 x



Hex Nut

12 x



Washer

STEP BY STEP

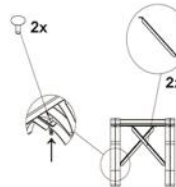
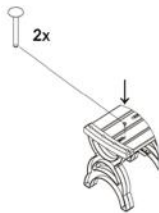
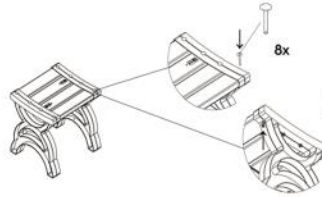
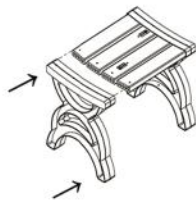
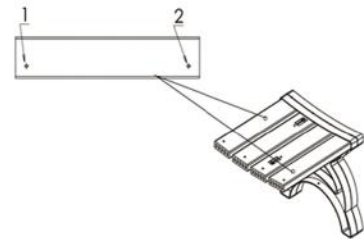
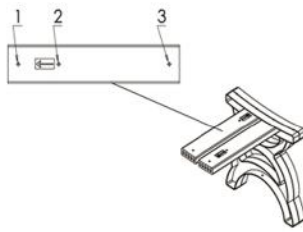

▼ END

Contact us:

For US Corporation:

www.foruseco.com

1-561-774 0707

In Brasil:

www.inbrasil.ind.br

+55 042 3135-5000



INSTRUCCIONES DE ENSAMBLE

Taburete | 45cm



| | | | |
|-----|-----------------|------|------------------|
| 1 x | Tabla Central | 10 x | Tornillo 2" |
| 2 x | Tabla lateral | 2 x | Tomillo 1" |
| 2 x | Pie lateral | 12 x | Tuerca Hexagonal |
| 2 x | Cierre plástico | 12 x | Arandela |

PIEZAS

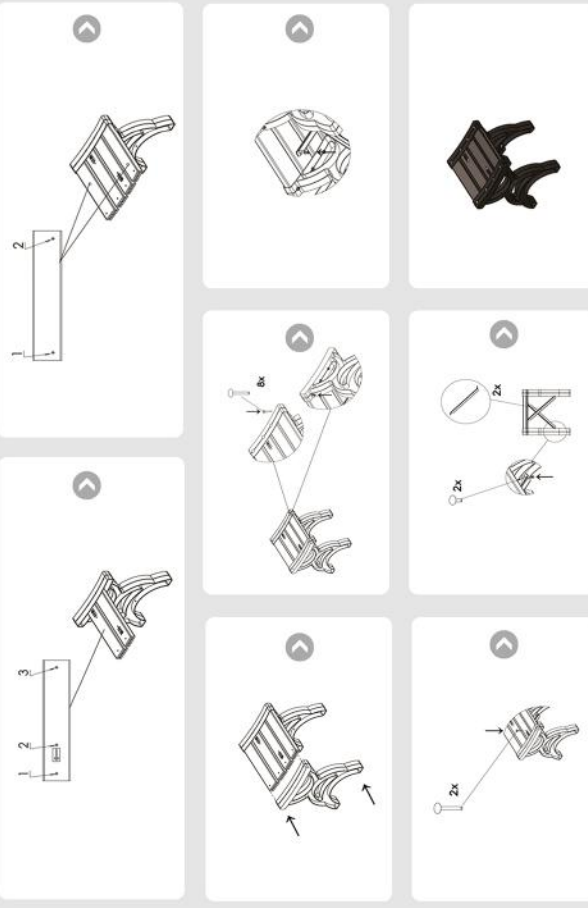

PASO A PASO

▼ FIN

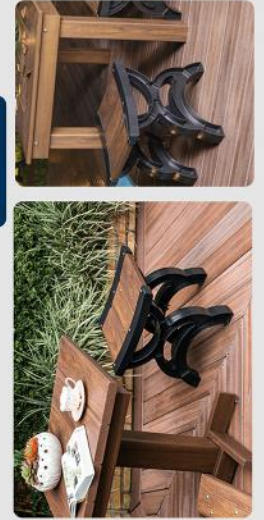

Contáctenos:
For US Corporation:
www.foruseco.com
1-561-774 0707

In Brasil:
www.inbrasil.ind.br
+55 042 3135-5000

MANUAL DE MONTAGEM

Banqueta | 45cm



| | | | |
|-----|----------------|------|---------------|
| 1 x | Tábua central | 10 x | Parafuso 2" |
| 2 x | Tábua lateral | 2 x | Parafuso 1" |
| 2 x | Pé lateral | 12 x | Porca sextava |
| 2 x | Trava plástica | 12 x | Arruela |

PEÇAS

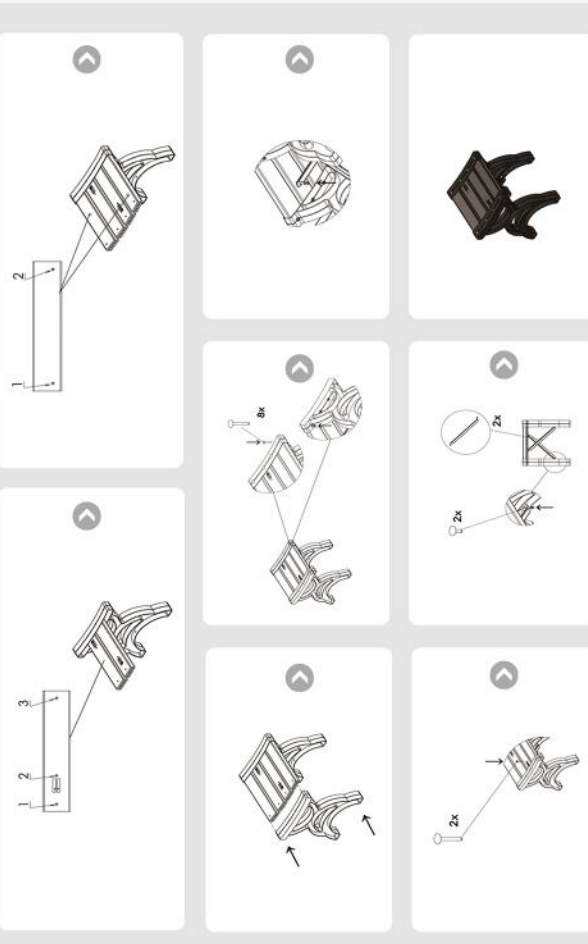

PASSO A PASSO

▼ FIM

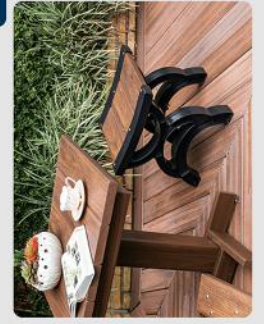

Fale com a gente:
For US Corporation:
www.foruseco.com
1-561-774 0707

In Brasil:
www.inbrasil.ind.br
+55 042 3135-5000